

## NEODYMIUM CHANNEL MAGNET WITH 2x COUNTERSUNK HOLE

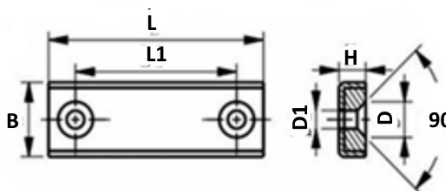

Model	L (mm)	L1 (mm)	B (mm)	H (mm)	D (mm)	D1 (mm)	Force (Kg)	Net Weight (g)
PME-NCM40	40	30	13.5	5	6.5	3.3	17	18.4
PME-NCM50	50	40	13.5	5	6.5	3.3	27	23.2
PME-NCM60	60	50	13.5	5	6.5	3.3	30	27.9
PME-NCM70	70	60	13.5	5	6.5	3.3	31	31.2
PME-NCM80	80	70	13.5	5	6.5	3.3	33	37.8
PME-NCM90	90	80	13.5	5	6.5	3.3	35	41.2
PME-NCM100	100	90	13.5	5	6.5	3.3	36	46.9
PME-NCM110	110	100	13.5	5	6.5	3.3	38	49.2
PME-NCM120	120	110	13.5	5	6.5	3.3	40	56.5

Grade: N35

Coating: Nickel

Visit to Link - <https://www.patelmagnets.com/neodymium-channel-magnet-with-2x-csk-hole/>